

REV.	ECN NO.	DESCRIPTION	DRAW	APPD.	DATE
A1	---	新版发行	ZXM	Steven.Xie	2018.07.02

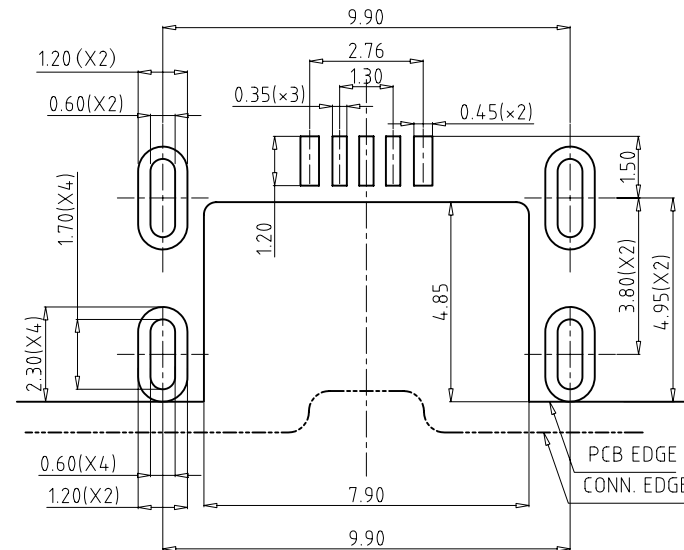

RECOMMENDED PCB LAYOUT(TOP VIEW)
GENERAL TOLERANCES:±0.05

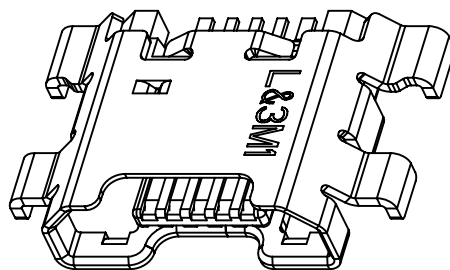
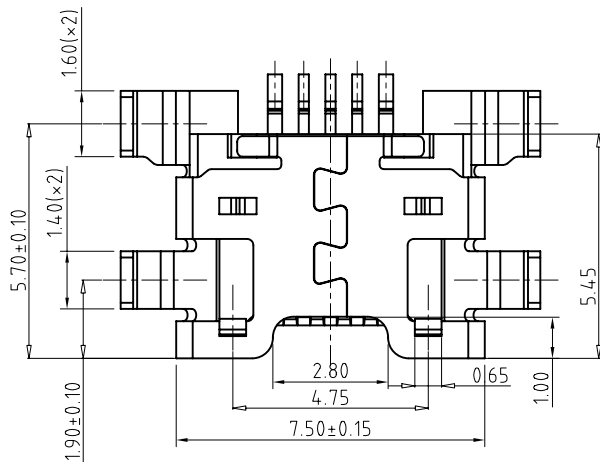
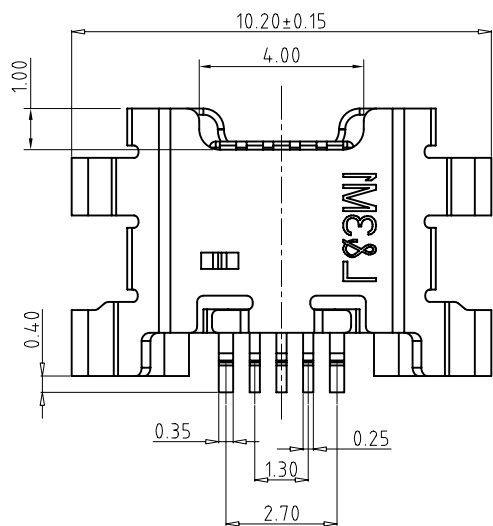
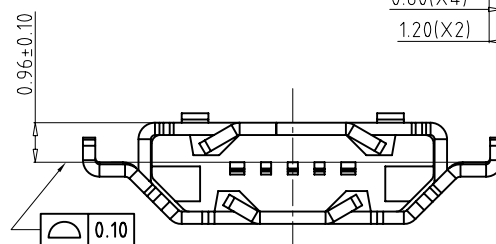
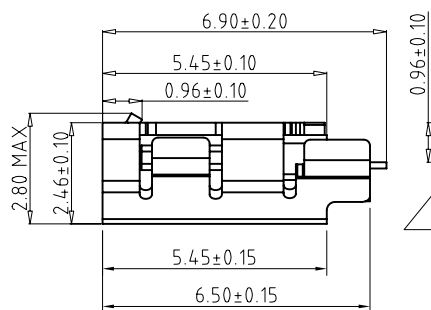
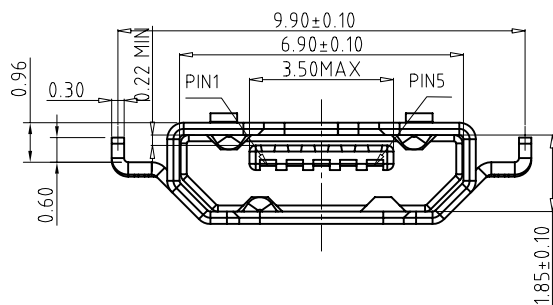

SPECIFICATION:

- 1 CURRENT RATING: 0.5A(2.3.4CONTACT)/1.8A(1.5CONTACT) MAX.
- 2 VOLTAGE: 30 VAC
- 3 TEMPERATURE RANGE: -30 °C ~ 85 °C
- 4 CONTACT RESISTANCE: 30 MILLIONHM MAX.
- 5 DIELECTRIC WITHSTANDING VOLTAGE: 250 VAC r.m.s
- 6 INSULATION RESISTNACE: 100 MEGOHMS MIN



3	CONTACT	COPPER ALLOY T=0.15mm	Au/Ni Plated	1PCS
2	HOUSING	High temperature plastic	BLACK	1SET
1	SHELL	STAINLESS STEEL T=0.30mm	MATTE TIN/Ni Plated	1PCS
NO.	DESCRIPTION	MATERIAL	REMARKS	QTY
TOLERANCE		NAME(INTENDED USE) CUSTOMER DRAWING		东莞市协展电子科技有限公司
X.X ±0.30	X.* ± 2*	PART NO.		
.XX ±0.20	.X* ± 1*	TITLE: MICRO USB 5P SMT TYPE 反向沉板1.0无翻边(HW CW-7X)		
.XXX ±0.10	.XX* ±0.5*	DRAWG NO.		
UNITS	mm	APPD:		
MATERILA		CHED:		
FINISH		DRAW:		
			SCALE	SHEET
			1:1	1/1
			REV.	A1